



P2 Innsbruck

Data and facts

Company	PORR Design & Engineering GmbH
Type	Sustainability, Architecture, Technical building services planning, Tender management, Building physics, Fire protection, Building Information Modeling (BIM), General planning, Structural design, Building certification, Building certification
Principal	Amraser Straße 2-4 Entwicklungs- und Beteiligungs-GmbH

[Project report online](#)

www.porr-group.com



New architectural landmark in the heart of Innsbruck

pde Integrale Planung GmbH, formerly PORR Design & Engineering, was commissioned with the P2's overall design in autumn 2015. This project drew on almost all the competences available at pde. After all, the project included a whole range of highly complex tasks:

- Project management and project leadership
- Architecture – draft, optimisation, replacement planning, execution planning
- Superstructure design – execution statics, form work and reinforcement planning
- Technical building equipment
- Building physics
- Certification in LEED Gold

Almost all performance phases around project P2 were implemented by pde.

Impressions

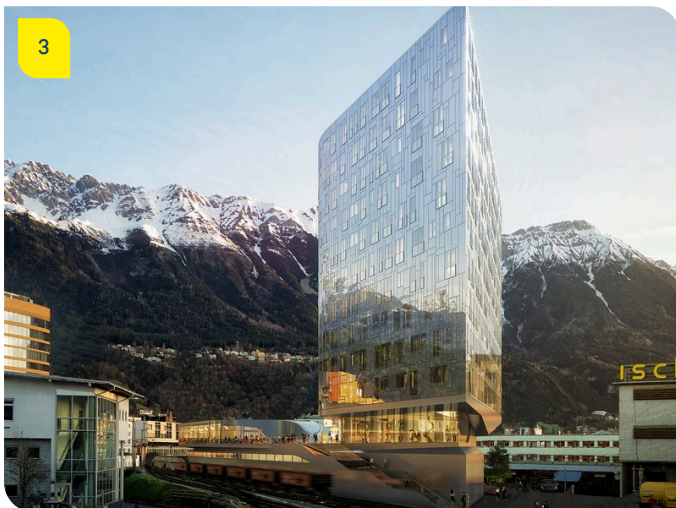
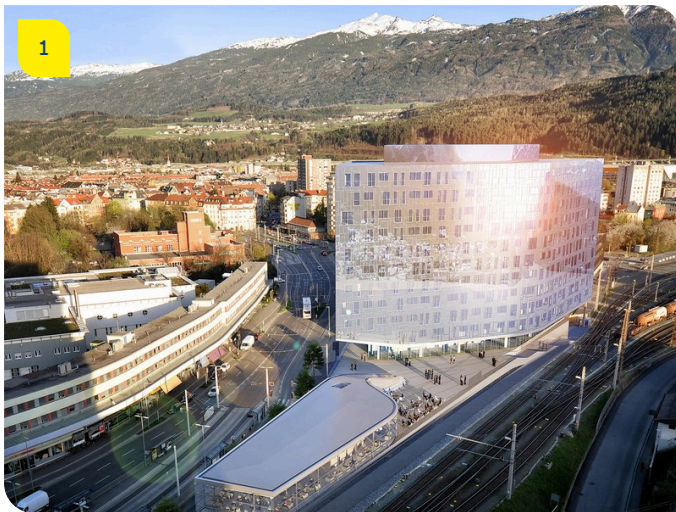

Image notes

1

P2 Innsbruck

Perfect inner-city location with a clear view of Tyrol's mountain landscape

3

P2 Innsbruck

The P2 in its commanding location

2

P2 Innsbruck

Visualisation P2 with library

Do you have questions about the project or would you like to learn more? Feel free to contact us for further information.

PORR AG Group Communications

Absberggasse 47

1100 Wien

T +43 50 626-0

E-Mail: comms@porr-group.com