



Office building LX2

Data and facts

Company	STRAUSS PROPERTY MANAGEMENT
---------	-----------------------------

Type	Office buildings
------	------------------

[Project report online](#)

www.porr-group.com



An office in an urban hub.

STRAUSS PROPERTY MANAGEMENT is responsible for managing this project, creating individual quarterly reports and managing the property's annual budget. STRAUSS PROPERTY MANAGEMENT staff visit the building on a regular basis and perform monthly inspections to ensure smooth operations.

Impressions

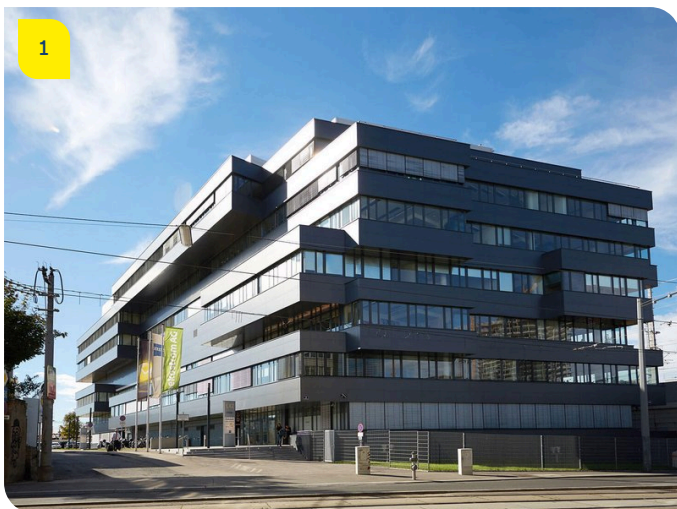

Image notes

1

State-of-the-art facilities in a top location.

The LX2 building's spectacular façade makes this office block a unique eye-catcher.

Do you have questions about the project or would you like to learn more? Feel free to contact us for further information.

PORR AG Group Communications

Absberggasse 47

1100 Wien

T +43 50 626-0

E-Mail: comms@porr-group.com